

Part Number: PT747-47170

Kit Contents

Item #	Quantity Req'd	Description
1	1	Applique, RR Bumper
2	1	

Hardware Bag Contents

Item #	Quantity Req'd	Description
1		

Additional Items Required For Installation

Item #	Quantity Req'd	Description
1		

Conflicts

None

Recommended Tools

Personal & Vehicle Protection

None

Special Tools

Squeegee 4" (3M™ Gold) or 4" (3M™ Silver)

Low Friction Sleeve 3M SA-1 (OPTIONAL)

Surface Thermometer Infrared Non-contact

Heat Gun Master Heat Gun HG-301A or equivalent

Installation Tools

Lint Free Rags

Spray Bottle For wetting agent

Special Chemicals

Cleaner VDC approved cleaner and cleaning method

Wetting Agent Johnson's Baby Shampoo mixed in one liter of water;

At 65°F add 2 ml. shampoo

At 70°F add 3 ml. shampoo

At 80°F add 3.5 ml. shampoo

At 90°F add 4 ml. shampoo one more ml. of shampoo.

General Applicability

All Prius Prime models.

Recommended Sequence of Application

Item #	Accessory
1	

Vehicle Service Parts (may be required for reassembly)

Item #	Quantity Req'd	Description
1		
2		
3		

Legend

STOP: Damage to the vehicle may occur. Do not proceed until process has been completed with.

OPERATOR SAFETY: Use caution to avoid risk of injury.

CAUTION: A process that must be carefully observed in order to reduce the risk of damage to the accessory/vehicle and to ensure a quality installation.

TOOLS & EQUIPMENT: Used in Figures calls out the specific tools and equipment recommended for this process.

REVISION MARK: This mark highlights a change in installation with respect to previous issue.

SAFETY TORQUE: This mark indicates that torque is related to safety.

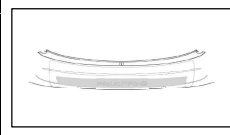

Issue: B 09/07/2016

Page 1 of 6 pages

Care must be taken when installing this accessory to ensure damage does not occur to the vehicle. The installation of this accessory should follow approved guidelines to ensure a quality installation.

These guidelines can be found in the "Accessory Installation Practices" document.

This document covers such items as:

- Vehicle Protection (use of covers and blankets, cleaning chemicals, etc.)
- Safety (eye protection, rechecking torque procedure, etc.)
- Vehicle Disassembly/Reassembly (panel removal, part storage, etc.)
- Electrical Component Disassembly/Reassembly (battery disconnection, connector removal, etc.)

Please see your Toyota dealer for a copy of this document.

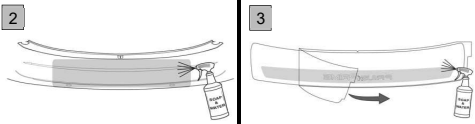
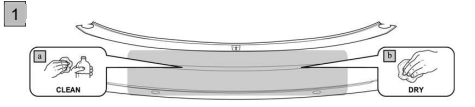
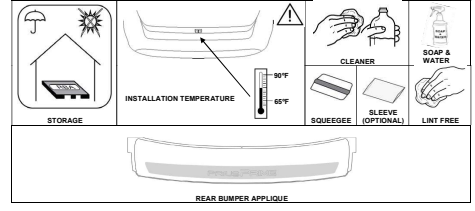

Issue: B 09/07/2016

Page 2 of 6 pages

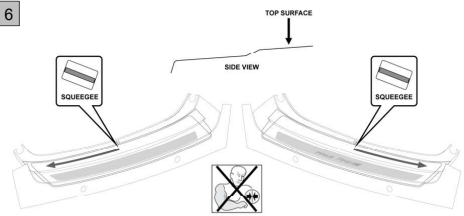
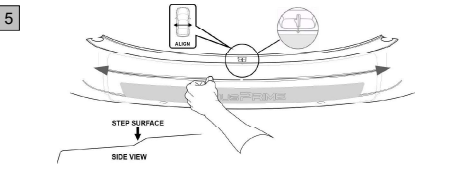
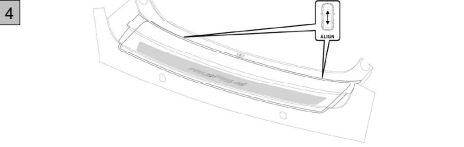

Issue: B 09/07/2016

Page 3 of 6 pages

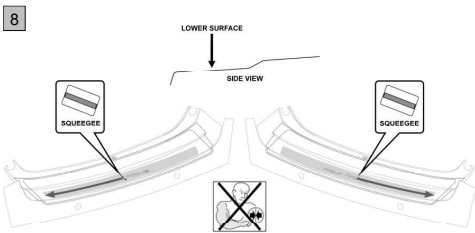
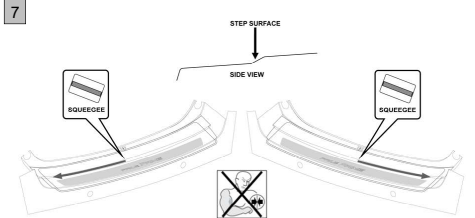

Issue: B 09/07/2016

Page 4 of 6 pages

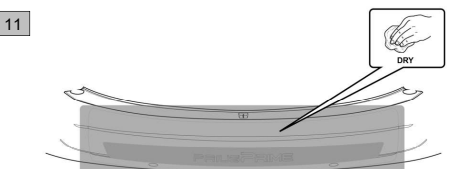
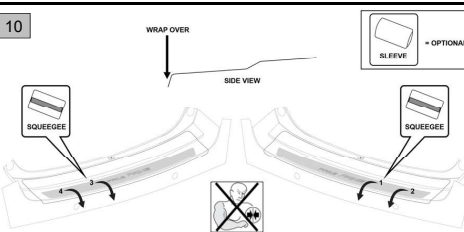
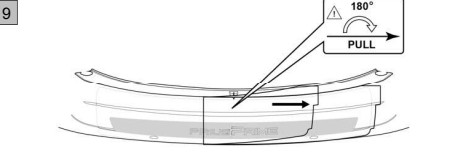

Issue: B 09/07/2016

Page 5 of 6 pages

Check:	Look For:
Accessory Function Checks <input type="checkbox"/> Proper adhesion - Visual <input type="checkbox"/> Proper adhesion - Physical <input type="checkbox"/> Proper alignment - Cross-Car	Look for bubbles, loose and lifting edges. With light pressure rub hand over top of part and if cracking occurs, re-squeegee. If bubbles cannot be worked out to the nearest edge, replace part. Part must be centered within bumper ± 3mm

Vehicle Appearance Check	
<input type="checkbox"/> After accessory installation and removal of protective cover(s), perform a visual inspection.	Ensure no damage (including scuffs and scratches) was caused during the installation process. (For PPO installations, refer to TMS Accessory Quality Shipping Standard.)

Issue: B 09/07/2016

Page 6 of 6 pages